

227 127  
 South Carolina Pursuant to a warrant from John Thomas Comr of locs N side Saluda dated 11<sup>th</sup> Jan<sup>y</sup> 1802, I have admeasured and laid out unto Johnson Ferguson a tract of Thirty Three acres of land in newberry District on a small branch waters of Sygar River bounded by lines running N 45° E. by land Survey for Thomas Hatcher, S. by a North Carolina Tract of land by land survey for James Crall, and both such shape & marks as the above Plat represents — recorded 16<sup>th</sup> Jan<sup>y</sup> 1802 Survey 14<sup>th</sup> Jan<sup>y</sup> 1802 Abner Nelson D.S.

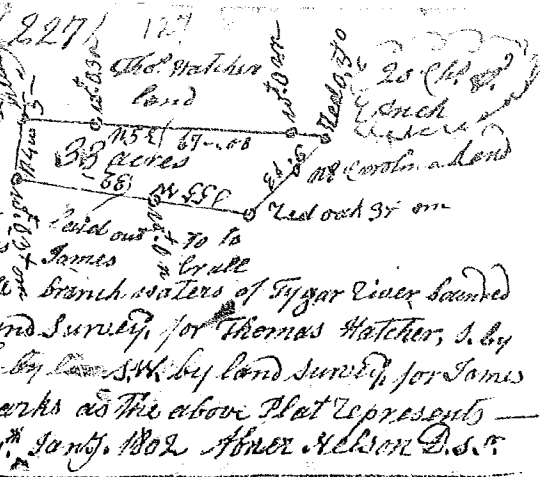

South Carolina Pursuant to a warrant from John Thomas Comr of locs N side Saluda dated 8<sup>th</sup> Jan<sup>y</sup> 1802 I have admeasured & laid out unto Daniel Welch a tract of fifty five acres of land in greenville District on a small branch of Reddy river, bounded by lines running S 2° E by James Broons land W by David Peden N by Andrew Cooper land William Welch land, and both such shape & marks as the above Plat represents, recorded 25<sup>th</sup> Jan<sup>y</sup> 1802 For Hilgore D.S.

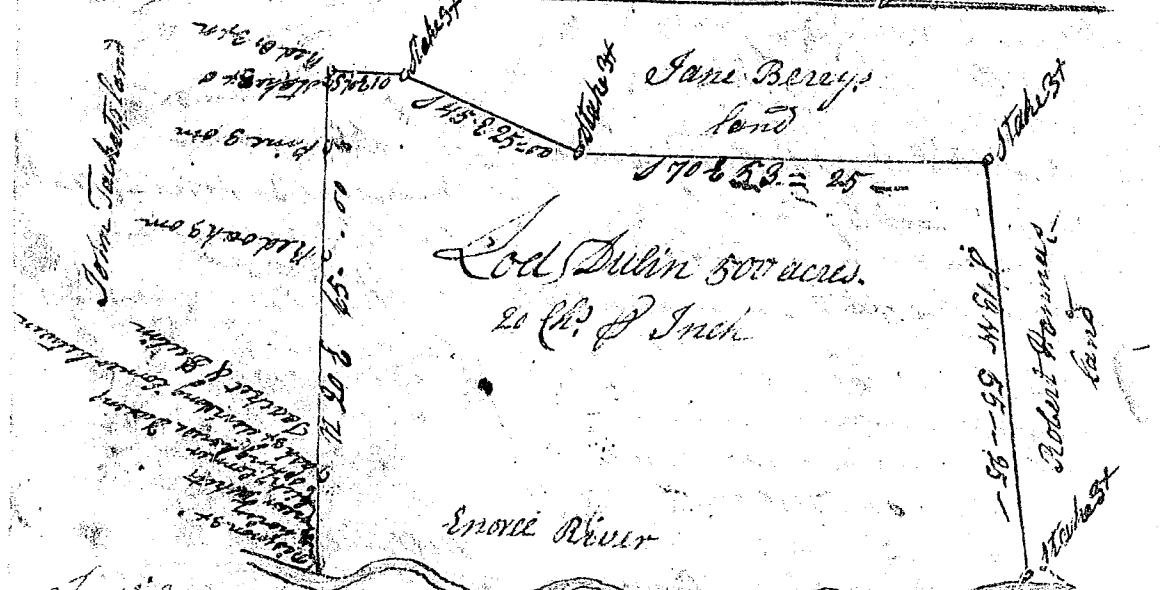
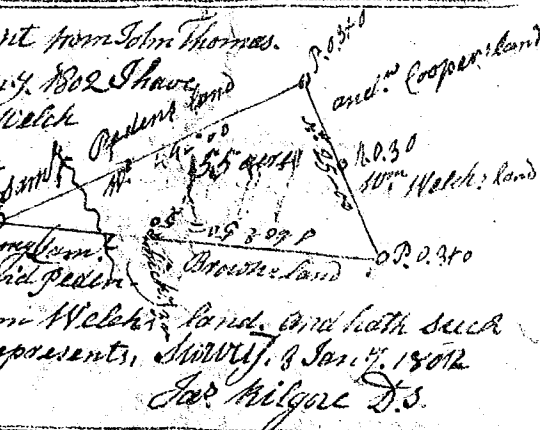

South Carolina Pursuant to a warrant from John Thomas Comr of locs N side Saluda dated 8<sup>th</sup> Jan<sup>y</sup> 1802 I have admeasured and laid out unto Lodi Dulin a tract of five hundred acres of land in Spartanburgh District, bounding N side of Enore River N side by John Tachet's land, N by Jane Berays land E by Robert Hannas land, including the plantation whereon said Lodi Dulin now lives on, and both such shape & marks as the above Plat represents — Survey 16<sup>th</sup> Jan<sup>y</sup> 1802, recorded 20<sup>th</sup> Jan<sup>y</sup> 1802 — For Hilgore D.S.